

REVISIONS				
ZONE	REV	DESCRIPTION	DATE	APPROVED

INSTALLATION DETAIL

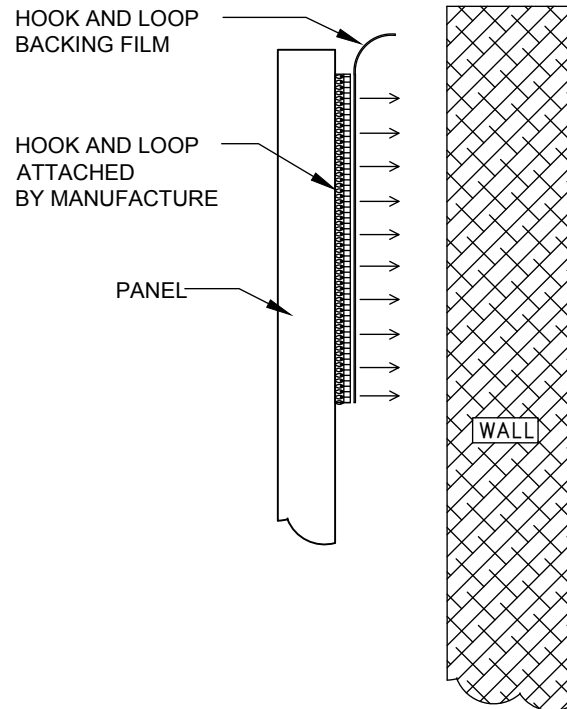

WALL INSTALLATION INSTRUCTIONS

1. DETERMINE WHERE PANELS ARE TO BE INSTALLED
2. CLEAN SURFACES WHERE ADHESIVE BACKING WILL CONTACT
3. JOIN HOOK & LOOP ON PANEL BACK, REMOVE BACKING FILM FROM WALL MOUNTING STRIPS
4. LOCATE AND PRESS PANEL FIRMLY ON WALL, LET ADHESIVE CURE BEFORE TRYING TO REMOVE PANEL FROM WALL. SPI DOES NOT RECOMMEND THIS MOUNTING METHOD WHEN SURFACE IS BLOCK, BRICK, OR CONCRETE.
5. WHEN USING HOOK & LOOP, PANELS SHOULD BE SUPPORTED BY SUPPORT ANGLE MOLDING (SUPPLIED BY OTHERS), CAPABLE OF CARRYING FULL PANEL WEIGHT.

NOTES

1. HOOK & LOOP PROVIDED BY SPI
2. TYPICAL HOOK & LOOP STRIPS TO BE 6 INCHES



ABSORPTION PLUS PANEL
IMPACT AND TACK PANEL

INSTALLATION INSTRUCTIONS
HOOK & LOOP

JAN. 12, 2012	SIZE A	FSCM NO.	DWG NO. 20000363	REV 4
	SCALE N/A	DRWN ZCH	SHEET 1 OF 1	